



Monte Carlo LS



Monte Carlo Z34

MONTE CARLO AND THE MARKETPLACE

Combining refinement with the level of performance enthusiasts expect, Monte Carlo is truly a car with a split-personality. Two distinctive models — the classy, luxurious LS and the performance-oriented Z34 — make it appealing to a wide customer base. Monte Carlo finished strong in 1997 with a model year sales volume of 73,595 units.

COMPETITORS

- Chrysler Sebring
- Dodge Avenger

DEMOGRAPHICS

- Median Age: Late-30s to Mid-40s
- Married: 59%
- College Graduate: 32%
- Median Income: \$57,000
- Purchaser: Male — 49%; Female — 51%
- Principal Driver: Male — 38%; Female — 62%

NEW FOR 1999

EXTERIOR/STRUCTURAL FEATURES

- Medium Auburn Nightmist Metallic replaces Deep Purple Metallic exterior paint treatment (page 7).



MODELS AND TRIM LEVELS

MONTE CARLO LS COUPE

LS Coupe provides these standard features:

Interior

- Next Generation driver and right front-passenger air bags*
- Air conditioning with CFC-free refrigerant
- Power door locks
- Tilt-Wheel™ steering column
- Electronically tuned AM/FM stereo with cassette player, automatic tone control, speed-compensated volume and TheftLock security feature
- Delayed entry/exit interior lighting with theatre dimming
- Custom Cloth 60/40 split-bench front seat with center storage armrest
- Split-folding rear seat
- Rear-seat safety belt child comfort guides
- Six-passenger seating
- Two cup holders (with 60/40 front seat)
- Rear-seat heat ducts
- Change Oil Soon indicator
- Scotchgard™ protection
- Intermittent windshield wiper system
- Tinted glass with Solar-Ray windshield and rear glass
- Power windows with driver's Express-Down feature
- Visor vanity mirrors, left-hand and illuminated right-hand
- Front-door storage compartments
- Carpeted front and rear floor mats
- Engine coolant temperature gauge
- Gauge package with tachometer
- Headlamps-on reminder tone.

Exterior

- Daytime Running Lamps with Automatic Exterior Lamp Control
- Two-sided galvanized steel — all body panels, except roof
- Color-keyed body-side moldings
- Dual body-color electric remote sport mirrors.

Functional

- 3100 V6 engine with 160 horsepower
- Electronically controlled 4-speed automatic overdrive transmission (4T60-E)
- 4-wheel antilock brake system (ABS)
- Power front disc/rear drum brakes
- Power rack-and-pinion steering
- 4-wheel independent suspension
- Battery-rundown protection
- 100,000-mile platinum-tip spark plugs†
- 150,000-mile extended-life engine coolant‡
- Low engine oil and coolant level warning lights
- 15-inch wheels with bolt-on wheel covers
- P205/70R-15 touring tires
- PASS-Key II theft-deterrent system
- Stainless-steel exhaust system.

*Always use safety belts and proper child restraints, even with Next Generation air bags. See the owner's manual for more safety information. †Maintenance needs vary with different uses and driving conditions.

MONTE CARLO Z34 COUPE

Z34 Coupe adds:

Interior

- Custom Cloth front bucket seats with center storage console
- Driver and front-passenger temperature controls
- Electronic speed control
- Luggage-area cargo net
- Power trunk opener
- Steering-wheel radio controls
- Leather-wrapped steering wheel.

Exterior

- Dual-outlet exhaust
- Front and rear red bowtie badging.

Functional

- 3800 Series II V6 engine with 200 horsepower
- Electronically controlled 4-speed automatic overdrive transmission (4T65-E)
- 4-wheel disc brake system with ABS
- Remote Keyless Entry system
- Ride and Handling Suspension
- 16-inch five-spoke machined-face aluminum wheels
- P225/60R-16 Goodyear Eagle RS-A performance tires.



SAFETY AND SECURITY

With a long history of setting automotive safety milestones, GM is a world leader in safety research, development and testing. 1999 Monte Carlo exemplifies that dedication, with a comprehensive system emphasizing crash avoidance and occupant protection features.

CRASH AVOIDANCE FEATURES

- **DAYTIME RUNNING LAMPS (DRL)** turn on automatically when the ignition is on and the parking brake is disengaged, to help increase Monte Carlo visibility to other drivers. The DRL system runs the headlamps at a reduced intensity compared to regular headlamp operation.
- **AUTOMATIC EXTERIOR LAMP CONTROL** works with Daytime Running Lamps and automatically activates the headlamps and all other exterior lamps to full intensity when light-sensitive sensors detect darkness for more than 20 seconds. The exterior lamps will shut off when the ignition is turned off.
- **4-WHEEL ANTILOCK BRAKE SYSTEM (ABS)**, standard on all models, automatically adjusts brake pressure to the front and rear wheels during hard braking situations, to help the driver maintain steering control by reducing wheel lockup (see page 11).
- **BRAKE/TRANSMISSION SHIFT INTERLOCK**, standard on all models, requires the driver to depress the brake pedal to shift out of Park.
- **CENTER-MOUNTED HORN** is easily activated by pressing anywhere on the steering wheel hub pad.

OCCUPANT PROTECTION FEATURES

Standard occupant protection features:

- **NEXT GENERATION DRIVER AND RIGHT FRONT-PASSENGER AIR BAGS*** inflate with reduced speed and deployment force, helping to reduce the risk of deployment injury. However, even with Next Generation air bags, never place a rear-facing infant restraint in the front seat of any vehicle with an active air bag.

- **THREE-POINT SAFETY BELT SYSTEM** helps restrain outboard passengers by distributing forces to help minimize injury.
- **REAR-SEAT SAFETY BELT CHILD COMFORT GUIDES** adjust the angle of safety belt crossover, making them more comfortable for older children and small adults riding in the backseat.



- **REINFORCED STEEL SAFETY-CAGE CONSTRUCTION** surrounds occupants with a cocoon-like system of structural components. This structure consists of reinforced roof rails, door pillars and side door beams, which are designed to minimize intrusion into the passenger compartment in shallow-angle side impacts.
- **FRONT AND REAR CRUSH ZONES** are designed to deform in a controlled manner in a collision to absorb impact energy in order to reduce intrusion into the passenger compartment.
- **ENERGY-ABSORBING STEERING COLUMN AND INSTRUMENT PANEL** are designed to absorb collision impact, to help reduce injury to the driver's body.

*Always use safety belts and proper child restraints, even with Next Generation air bags. See owner's manual for more safety information.

SECURITY FEATURES

- **BATTERY-RUNDOWN PROTECTION** automatically shuts off interior lights if they are accidentally left on for 10 minutes with the engine off. If Monte Carlo is left with the ignition off for more than 24 days, the system cuts power to accessories such as the clock and sound system settings, helping prevent battery rundown.
- **PASS-KEY II THEFT-DETERRENT SYSTEM**, standard on all models, allows the ignition and fuel systems to be activated only when the computer reads the resistance pellet on the key. This means only the specially coded key starts each Monte Carlo.



- **REMOTE HOOD RELEASE** is standard on all Monte Carlo models and helps prevent unauthorized access to the engine compartment from outside the vehicle.
- **LASER-ETCHED VEHICLE IDENTIFICATION NUMBER (VIN)** plate makes forgery more difficult than with stamped VIN plates.

INTERIOR FEATURES

Standard features:

- **60/40 SPLIT-BENCH FRONT SEAT** with full foam construction allows comfortable seating for up to six passengers on Monte Carlo LS. It includes the added convenience of a center armrest with fold-out cup holder and storage compartment. Models equipped with this seat configuration also feature a pull-out cup holder in the instrument panel.
- **AIR CONDITIONING** uses CFC-free refrigerant. The air conditioning compressor is automatically activated to help avoid window "flash fogging" when the defrost mode is selected.
- **POWER DOOR LOCKS** secure both doors at the touch of a button.
- **CHANGE OIL SOON** indicator illuminates when it's time to change the engine oil. This system also is sensitive to driving habits and conditions. Therefore, the light may come on as early as 2,000 miles or sooner in harsh driving conditions.
- **DELAYED ENTRY/EXIT INTERIOR LIGHTING WITH THEATRE DIMMING** slowly dims interior lights after the doors are closed (instead of shutting them off abruptly).
- **AUXILIARY LIGHTING** includes dome, dual reading, glove box and trunk lights for convenience.
- **SPLIT-FOLDING REAR SEAT** provides cargo-carrying flexibility.
- **INTEGRATED REAR-SEAT HEAT DUCTS** maximize rear-passenger comfort.
- **REAR-SEAT SAFETY BELT CHILD COMFORT GUIDES** adjust the angle of safety belt crossover, making wearing safety belts more comfortable for older children and small adults riding in the backseat.
- **VARIABLE INTERMITTENT WINDSHIELD WIPERS** allow the driver to match wiper speed with weather conditions.
- **TILT-WHEEL™ STEERING COLUMN** helps tailor the wheel to the most comfortable, individualized driving position.
- **SCOTCHGARD™ PROTECTION** helps protect cloth seating surfaces, door panel trim and carpeting from stains and helps make cleanups easy.
- **REMOTE KEYLESS ENTRY SYSTEM** (standard on Z34 and optional on LS model) transmits a uniquely coded, high frequency radio signal to lock or unlock doors and unlock the trunk from up to 30 feet away.
- **DRIVER AND FRONT-PASSENGER TEMPERATURE CONTROLS** (standard on Z34 and optional on LS model) allow the driver and front passenger to vary temperature levels to suit individual preferences.
- **POWER WINDOWS** provide added convenience; the driver's Express-Down feature allows lowering of the driver window by a single touch.
- **ELECTRONIC SPEED CONTROL** (standard on Z34 and optional on LS models) includes resume and accelerate features.
- **SIDE-WINDOW DEFOGGERS** help provide a clear view of the road through the driver and front-passenger windows.
- **CENTER CONSOLE** (standard on Z34 and optional on LS model) houses a cup holder, driver or front-passenger armrest and storage area for tapes, cellular phones, etc.
- **LUGGAGE-AREA CARGO NET** (standard on Z34 and optional on LS model) helps secure groceries and other small cargo from sliding around in the trunk.
- **COVERED VISOR VANITY MIRRORS** are standard for both the driver and front passenger. The front-passenger mirror illuminates for nighttime convenience.
- **RADIO AND HVAC CONTROLS** are easy to reach and operate, even while wearing gloves.
- **STEERING WHEEL RADIO CONTROLS** (standard on Z34, optional on LS) feature Play, Mute, Volume, Seek, AM/FM and Preset buttons for convenience at the fingertips. This feature also includes a leather-wrapped steering wheel.
- **GLOVE BOX** provides ample storage for the owner's manual and other small items.



- **FRONT-DOOR STORAGE COMPARTMENTS AND SEATBACK STORAGE POCKETS** hold maps or other small personal items.
- **JACK STOWAGE TRAY** securely holds and houses the jack parts helping to reduce rattles.
- **CARPETED FRONT AND REAR FLOOR MATS AND FULL TRUNK CARPETING** are standard on all models.

Optional features:

- **ONSTAR COMMUNICATIONS SYSTEM** (wiring accommodations included on LS and Z34 models) gives 24-hour access to the OnStar center, which offers route support, roadside assistance and convenience services — all through the dealer-installed cellular phone system.
- **DEEP-TINTED POWER SLIDING SUNROOF WITH VENT FEATURE** opens at the touch of a button and includes a sunshade to protect the vehicle's interior from sun-fading.
- **6-WAY POWER DRIVER SEAT** allows precise seat adjustment for maximum comfort.
- **ELECTRIC REAR-WINDOW DEFOGGER** clears the rear window quickly and easily.

SOUND SYSTEMS

- **ELECTRONICALLY TUNED AM/FM STEREO WITH CASSETTE PLAYER**, TheftLock security feature, speed-compensated volume, automatic tone control, seek-scan and digital clock is standard on all models. It includes premium coaxial front and rear speakers.
- **ELECTRONICALLY TUNED AM/FM STEREO WITH COMPACT DISC PLAYER**, TheftLock security feature, speed-compensated volume, automatic tone control and digital clock is optional on all models. It includes premium coaxial front and rear speakers.

Uplevel cassette and compact disc player systems feature:

- **SPEED-COMPENSATED VOLUME** automatically regulates the volume of the audio to help overcome road noise, so the volume level adjusts to the vehicle's speed.
- **AUTOMATIC TONE CONTROL** allows the listener to choose preset bass and treble settings designed for classical, news, rock, pop, country/western and jazz stations.

- **THEFTLOCK SECURITY FEATURE** helps prevent theft by making the unit non-functional if removed from the instrument panel.
- **AVAILABLE STEERING WHEEL RADIO CONTROLS**, standard on Z34, optional on LS, feature Play, Mute, Volume, Seek, AM/FM and Preset buttons for added convenience.

SEATS



LS Coupe

- Custom Cloth 60/40 split-bench front seat with center storage armrest and cup holder (standard on LS Coupe).



LS Coupe, Z34 Coupe

- Custom Cloth front bucket seats with storage console and cup holder (optional on LS Coupe, standard on Z34).



LS Coupe, Z34 Coupe

- Front bucket seats with leather seating surfaces, center storage console and cup holder (optional on LS Coupe, standard on Z34).

Other seating features:

- **MANUAL FOUR-WAY SEAT ADJUSTERS AND ADJUSTABLE HEAD RESTRAINTS** provide excellent driver support and comfort.
- **SIX-WAY POWER DRIVER SEAT ADJUSTER**, optional on all models for added driver convenience.
- **"FRENCH-STITCHED" SEAMS** create a clean, uplevel and contemporary appearance.

INTERIOR COLORS

Cloth colors:

- Medium Gray
- Graphite
- Neutral
- Medium Blue.

Leather seating surface colors:

- Graphite
- Neutral.

EXTERIOR/ STRUCTURAL FEATURES

EXTERIOR FEATURES

Monte Carlo standard exterior features:

- **BODY-COLOR ELECTRIC REMOTE SPORT OUTSIDE REARVIEW MIRRORS** add to the sporty appeal and adjustment convenience.
- **COMPOSITE HALOGEN HEADLAMPS** provide a high level of illumination.
- **WIRE-WRAPPED RADIO ANTENNA** reduces wind noise helping contribute to a quieter ride.
- **16.6-GALLON FUEL TANK** (approx.) allows a lengthy cruising range between fill-ups.
- **EASY-OPEN GAS CAP** is spring-loaded for quick opening and closing. It also creates a tight vacuum seal and works with the Enhanced Evaporative Emissions Control system, part of On-Board Diagnostics Second Generation (OBD II).
- **FUEL SPLASH-BACK PROTECTION** is provided by a small plastic ball in the filler neck tube that rises with the fuel level as the tank is being filled.
- **STAINLESS-STEEL EXHAUST SYSTEM** includes pipes, catalytic converter and muffler that resist corrosion and thereby reduce long-term cost of ownership.
- **CORROSION PROTECTION** has been incorporated throughout the vehicle. All exterior body panels, except the roof, use two-sided galvanized steel.

Monte Carlo optional exterior features:

- **REAR DECKLID SPOILER** enhances the sporty look.

STRUCTURAL FEATURES

The Monte Carlo body structure includes features designed to contribute to a quiet interior that has minimal squeaks and rattles. Helping achieve those effects are:

- **FIVE LATERAL CROSS MEMBERS** providing structural support and rigidity.
- **HYDRO-FORMED CROSS-CAR BEAM** serves as the backbone of the instrument panel.
- **CLOTH-COVERED FIBERGLASS HEADLINER** with sound-absorbing qualities.



- **NOISE-CONTROL PATCHES**, between the passenger and engine compartments, help keep engine and road noise from entering the interior. To help accomplish this, several of these areas feature sandwich-steel construction (metal, plastic, metal).

EXTERIOR PAINT

Standard basecoat/clearcoat paint on Monte Carlo resists fading and provides a high gloss shine for long-lasting exterior beauty. The clearcoat system is formulated to reduce the effects of acid rain and other environmental damage. Clearcoat finish is used with all colors — solids and metallics. The paint process builds up six layers of protection on every new Monte Carlo. This six-layer process includes:

- **ZINC-PHOSPHATE COATING** is applied to the bare metal.
- **TOTAL IMMERSION PHOSPHATE ELECTRODEPOSITION PRIMER (ELPO)** process is applied to the first layer of primer/paint. Electric current is applied to the body structure and panels while they are submerged in the paint bath to facilitate complete coverage, even in hard-to-reach areas.
- **SPRAYED-ON PRIMER** surface further insures corrosion resistance.
- **ANTI-CHIP PRIMER** is applied to lower body panel areas to protect against paint-chipping.
- **BASECOAT IN BODY COLOR** provides a deep, rich, uniformed color.
- **CLEARCOAT** provides a high luster and high level of protection.

PAINT COLORS

NEW Paint Colors For '99:

- Medium Auburn Nightmist Metallic.

Other colors:

- Black
- Medium Regal Blue Metallic
- Navy Blue Metallic
- Light Driftwood Metallic
- Dark Jade Green Metallic
- Light Pewter Metallic
- Dark Carmine Red Metallic
- Torch Red
- Bright White.

DESIGN AND MANUFACTURING

Prior to the introduction of an all-new body style in the 1995 model year, Monte Carlo and Lumina, had the most extensive pre-launch research conducted for new Chevrolet models up to that time. The Monte Carlo design was driven by feedback from that research, including:

- **CUSTOMER CLINICS.** More than 2,000 people provided input in focus groups regarding their concerns about safety, comfort and convenience, styling, price and value.
- **CHEVROLET DEALER AND CUSTOMER INPUT.** 120 changes were made to the original design due to input from dealer advisory groups and customers. As a result, Monte Carlo is designed, inside and out, to meet the needs of midsize coupe buyers. And, that design is carried through the manufacturing process at the General Motors assembly plant in Oshawa, Ontario, Canada.



ENGINES



3100 V6 SFI ENGINE (L82)

All Monte Carlo LS models are equipped with a standard 60-degree 3100 V6 engine with Sequential Fuel Injection (SFI). SFI delivers precise amounts of fuel through injectors at each cylinder, optimizing fuel efficiency, quick start-ups in all weather conditions and smooth acceleration.

Power ratings for the 3100 V6 engine are:

- **160 HORSEPOWER** at 5200 rpm
- **185 LB.-FT. TORQUE** at 4000 rpm.

3100 V6 engine technical features:

- **ROLLER ROCKER ARMS** act as roller bearings to reduce noise and friction between camshaft lobes and contacting surfaces of the rocker arms.
- **MASS AIRFLOW SENSOR** renders precise air metering and control of the air-to-fuel ratio.
- **"HIGH-RESOLUTION" IGNITION SYSTEM** produces a fast ignition and smooth idle.
- **"ASSEMBLED" CAMSHAFT** is made up of individual lobes permanently locked onto a weight-saving tube, yielding a stable idle and impressive durability.
- **DIE-CAST ALUMINUM STRUCTURAL OIL PAN** is "cross-bolted" to the main bearing caps to supply added strength and rigidity while helping to reduce noise.

- **TORQUE AXIS ENGINE MOUNT SYSTEM**, the heart of which consists of two fluid-filled engine and transmission mounts that "absorb" or "dampen" engine vibrations, contributing to a solid, stable ride with reduced engine noise and virtually unnoticeable idle.
- **ON-BOARD DIAGNOSTICS SECOND GENERATION (OBD II)** is combined with the Powertrain Control Module (PCM) to monitor fuel delivery, ignition timing and the emissions system, helping detect deterioration or malfunction.
- **CHANGE OIL SOON INDICATOR** illuminates when it's time to change the engine oil. This system also is sensitive to driving habits and conditions. Therefore, the light may come on as early as 2,000 miles or sooner in harsh driving conditions.
- **OIL LEVEL AND COOLANT SENSORS** alert the driver when fluids are low, helping avoid engine damage.
- **LOW MAINTENANCE** due to platinum-tip spark plugs which can go up to 100,000 miles before the first scheduled replacement* and extended-life engine coolant that lasts up to five years or 150,000 miles, whichever comes first.*

*Maintenance needs vary with different uses and driving conditions. See owner's manual for more information.



3800 SERIES II V6 ENGINE (L36)

The 90-degree 3800 Series II V6 engine is standard on Z34. It offers a level of power many wouldn't expect from a midsize coupe.

Power ratings for the 3800 Series II V6 engine are:

- **200 HORSEPOWER** at 5200 rpm
- **225 LB.-FT. OF TORQUE** at 4000 rpm.



3800 Series II V6 engine technical features:

- **BROAD TORQUE BAND** for powerful acceleration which is usually desired during stop-and-go driving.
- **PROVEN OVERHEAD VALVE (OHV) DESIGN** provides plenty of low-speed and mid-range torque for maneuvering in heavy traffic situations.
- **HIGH PERFORMANCE PUSHROD VALVETRAIN** allows the Series II engine to rev to 6000 rpm, making it competitive with multi-valve overhead camshaft (OHC) designs.
- **FEWER PARTS THAN AN OVERHEAD CAM ENGINE** with lighter weight valves, springs and spring caps, contributing to increased mechanical stiffness and allowing high maximum rpm capacity and impressive horsepower.
- **SYMMETRICAL PORTS AND COMBUSTION CHAMBERS** provide uniform combustion in all cylinders for smooth engine performance.
- **SEQUENTIAL FUEL INJECTION (SFI)** delivers exact amounts of fuel through injectors at each cylinder, optimizing fuel efficiency, quick start-ups in all weather conditions and smooth acceleration.
- **ON-BOARD DIAGNOSTICS SECOND GENERATION (OBD II)** is combined with the Powertrain Control Module (PCM) to monitor fuel delivery, ignition timing and the emissions system, to help detect deterioration or malfunction.
- **DUAL ELECTRONIC SPARK CONTROL (ESC)** sensors detect "knock" in all cylinders and drive the PCM coolant and instrument panel gauges for greater precision.
- **REFINED AIR MANAGEMENT** with a glass-reinforced nylon composite intake manifold and air induction system provides a linear acceleration curve for even performance throughout the driving range.
- **TUNED-FOR-PERFORMANCE THROTTLE BODY** features a large inlet and progressive camshaft and cable linkages for enhanced engine airflow and performance.
- **DIRECT ACCESSORY MOUNTING** of the power steering pump, alternator bracket and other brackets and tensioners reduce engine noise and vibration.
- **LAMINATED OIL PAN** is designed with a special gasket, integrated baffle and rear crankshaft seal carrier to help reduce noise and improve seals.
- **CHANGE OIL SOON** indicator illuminates when it's time to change the engine oil. This system also is sensitive to driving habits and conditions, therefore, the light may come on as early as 2,000 miles or sooner in harsh driving conditions.
- **EASY AND CLEAN OIL SERVICING** with convenient under-the-hood access and extended funnel-like oil-filling cap.
- **QUIET EXHAUST SYSTEM**, thanks to a cast-iron left manifold, insulated cross-over pipe and air gap take-down pipe.
- **LOW MAINTENANCE** due to platinum-tip spark plugs which can go up to 100,000 miles before the first scheduled replacement* and extended-life engine coolant that lasts up to five years or 150,000 miles, whichever comes first.*

*Maintenance needs vary with different uses and driving conditions. See owner's manual for more information.



TRANSMISSIONS

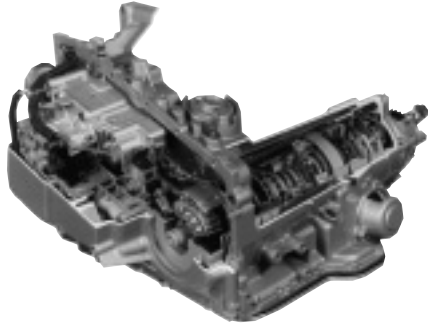

4T60-E 4-SPEED AUTOMATIC OVERDRIVE TRANSMISSION

The 4T60-E 4-speed electronically controlled automatic transmission has a wide range of gear ratios, enhancing performance and fuel economy on Monte Carlo LS models.

4T60-E features:

- **POWERTRAIN CONTROL MODULE (PCM)** improves shift quality. Shifts are so smooth, drivers may be unaware of the unit's operation. The PCM also monitors environmental factors, such as altitude and temperature, to create a more seamless link between engine, transmission and vehicle.
- **ELECTRONICALLY CONTROLLED CONVERTER CLUTCH (EC3)** varies the clutch capacity. Benefits include improved driveability.
- **2.92:1 FIRST GEAR RATIO** provides high torque multiplication for initial acceleration.
- **0.70:1 FOURTH GEAR OVERDRIVE** reduces wear and engine rpm at cruising speeds, helping increase fuel economy.
- **TEMPERATURE SENSOR** helps the transmission to compensate for severe operating conditions such as trailering or climbing steep grades.
- **CAST-ALUMINUM SIDE COVER** provides extra structural rigidity, sealing, heat dissipation and lower noise and vibration.
- **LONG-LIFE AUTOMATIC TRANSMISSION FLUID** has a fluid change interval of 100,000 miles.* This can have an important environmental impact since people will dispose of less transmission fluid.

*Maintenance needs vary with different uses and driving conditions. See the owner's manual for more information.

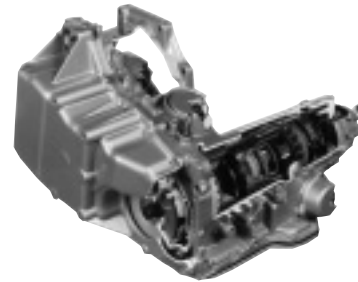

4T65-E 4-SPEED AUTOMATIC OVERDRIVE TRANSMISSION

The 4T65-E 4-speed electronically controlled automatic transmission is standard on Monte Carlo Z34 models as it is teamed with the 3800 Series II V6 engine. Since the 4T65-E is designed to handle high performance levels, it has some special features in addition to the features on the 4T60-E.

4T65-E adds:

- **DUAL-PHASE SPROCKET** drives two half-width chains, which rotate 180 degrees out of phase, causing the gear noise generated by each chain to "cancel out" one another.
- **FAMILY OF ELECTRONIC CONTROLS** that:
 - Protect against over-revving the engine in low-range gears.
 - Monitor changes in driving conditions and adjust shift quality, when necessary, for overall smooth shifting.

SUSPENSION

All Monte Carlo LS models feature a standard 4-wheel independent Soft-Ride Suspension that's specially tuned to provide a comfortable ride, plus responsive and predictable handling. The suspension also is tuned to maximize the tight, solid body structure. This 4-wheel independent suspension features:

- **32MM FRONT AND 16MM REAR STABILIZER BAR** reduce vehicle body lean, while turning.
- **MACPHERSON STRUTS** with specially tuned deflected disc shock valving, at all four corners, for a smooth ride.
- **VARIABLE-RATE COIL SPRINGS** help maintain comfortable and smooth ride characteristics, even with load variances.



For a more performance-oriented feel, Monte Carlo Z34 has a Ride and Handling Suspension, designed to handle high performance driving characteristics with the 3800 Series II V6 engine. The following are some of its special features:

- **FOUR-STAGE FRONT STRUT VALVING** allows a finer degree of ride control over a wide range of suspension movement.
- **34MM FRONT AND 20MM REAR STABILIZER BARS** further reduce vehicle body lean, while cornering.

STEERING

For precise control under demanding driving conditions, power-assisted rack-and-pinion steering is standard on all Monte Carlo models. This system includes a 15.7:1 ratio for quick steering response.

BRAKES

Monte Carlo LS models have front disc/rear drum brakes with standard power assist. And, Z34 models have standard power 4-wheel disc brakes.

Both models feature GM's ABS VI 4-wheel antilock brake system as standard equipment. Some things to keep in mind about ABS:

- ABS helps maintain steering control during severe braking situations by minimizing wheel lockup on most slippery surfaces. All the driver has to do is maintain pressure on the brake pedal and steer the vehicle.
- ABS adjusts brake pressure by modulating the brakes several times per second, a rate even most skilled professional drivers cannot attain physically.
- The system modulates the brake-line pressure at the wheels. Drivers should not "pump" the brakes in emergency braking situations. Rather, they should maintain constant pressure on the brake pedal, allowing the system to work effectively.

WHEELS AND TIRES



Monte Carlo LS:

- Standard 15" deluxe bolt-on wheel covers and P205/70R-15 all-season touring tires.



Monte Carlo LS:

- Optional 16" sporty aluminum wheel with chrome bowtie center cap. Requires P225/60R-16 all-season touring tires.



Monte Carlo Z34:

- Standard 16" machined-face aluminum wheel with red bowtie centercap and P225/60R-16 Goodyear Eagle RS-A performance tires.



HISTORY

(BY MODEL YEAR)

Monte Carlo was first introduced in September 1969 as a 1970 model combining personal luxury car attributes with Chevrolet value.

- 1970** – 454 cu. in., 360 hp SS 454 introduced.
- 1973** – Second-generation Monte Carlo design debuted; “S” and “Landau” Packages added.
- 1976** – Restyled front end; 454 cu. in. V8 engine discontinued.
- 1978** – Third-generation Monte Carlo introduced; first V6 engine became available.
- 1980** – Turbocharged 3.8L, 170hp V6 engine introduced.
- 1981** – New exterior design; Computer Command Control introduced.
- 1982** – Diesel V6 and V8 engines debut. Turbo V6 and Landau discontinued.
- 1983** – SS model debuted mid-year.
- 1986** – SS Aero Coupe and Luxury Sport models debuted.
- 1988** – Monte Carlo discontinued mid-year.
- 1995** – Fourth-generation Monte Carlo introduced, 4-wheel disc brakes standard on Z34.
- 1996** – Driver and front-passenger temperature controls (optional on LS, standard on Z34), extended-life automatic transmission fluid debuted.
- 1997** – Optional power sunroof, Daytime Running Lamps and Change Oil Soon indicator introduced.
- 1998** – Optional rear decklid spoiler becomes available; new machined-face aluminum wheels available for Z34 models, 3800 Series II V6 engine becomes standard on Z34.

CHEVROLET INTERNATIONAL

The Monte Carlo is sold in other countries besides the U.S. In many cases, changes are made in the vehicle's specifications to meet the unique demands of those markets and/or comply with local regulations.

Additionally, these products sometimes fill a very different role in non-U.S. markets. If you need to know what the differences are, in specifications or marketing strategies, in any given country, please look in the Chevrolet International section of this publication to identify the right GM person to contact for that kind of information. Chevrolet Communications (U.S.) does not have those details.

AFFINITY RELATIONSHIPS

Because Chevrolet offers the most comprehensive lineup of cars and trucks of any automotive manufacturer, it goes without saying that there is a product for virtually everyone, whatever their needs. From the bass fisherman who needs a reliable truck to tow his fishing boat, to the soccer mom who needs a dependable van to get the team to the field, Chevrolet can offer a vehicle to fit anyone's lifestyle.

With this in mind, Chevrolet created what has come to be known as “Affinity Marketing.” Through it, Chevrolet has developed relationships with over eighty lifestyle organizations, sporting groups and spokespeople that represent the image of Chevrolet cars, trucks and the people who drive them. These relationships help Chevrolet market its products and services while offering marketing support to groups like the United States Figure Skating Association and Ducks Unlimited. Affinity Marketing also builds relationships with individuals. These people, like country music star George Strait, reflect the Chevrolet vision of excellence.

Monte Carlo has affinity relationships with:

- NASCAR Winston Cup Series
- NASCAR Busch Series.

For more information, call 1-800-CHEVY-MI.



GENUINE **CUSTOMER CARE**

Chevrolet owners are covered by Genuine Customer Care, a comprehensive owner protection plan that includes the following:

NEW VEHICLE LIMITED WARRANTY

This warranty is for GM vehicles in the United States. Owners should see their Chevrolet dealer for complete terms and conditions of this New Vehicle Limited Warranty. Items covered for 3 years or 36,000 miles* for manufacturer's defects include:

- The complete vehicle
- Tires
- Towing to the nearest Chevrolet dealership
- Sheet-metal coverage
 - Corrosion coverage
 - Rust-through coverage[†]
- Repairs made to correct any vehicle defect
- No charge for most warranty repairs.

*Whichever comes first. For manufacturer defects.

[†]Six years or 100,000 miles, whichever comes first.

COURTESY TRANSPORTATION

Retail customers who purchase or lease a 1999 Chevrolet car or truck are eligible for Courtesy Transportation when their vehicles are left at a participating dealership for repairs covered under the 3-year/36,000-mile New Vehicle Limited Warranty. Courtesy Transportation, at participating dealerships only, may include shuttle service, expense reimbursement or, if the repairs require leaving the vehicle overnight, a vehicle rental. Actual services may vary at the election of the participating dealer. Owners should see their dealer for details.

ROADSIDE ASSISTANCE*

Roadside Assistance service is provided through a toll-free 800 number, 24 hours a day, 365 days a year. Roadside Assistance advisors can assist with minor mechanical concerns over the phone or coordinate a variety of services through professional service providers.

Basic Care provides:

- Toll-free access — 1-800-CHEV-USA
- Free towing to closest dealer for warranty repairs
- Basic over-the-phone technical advice
- Dealer services at reasonable costs (i.e., wrecker services, locksmith/key service, glass repair, etc.).

Courtesy Care applies for 3 years/36,000 miles and provides:

- Basic Care services
- Free locksmith/key service (when keys are lost on the road or locked inside)
- Free flat tire change service
- Free fuel delivery
- Free non-warranty towing
- Free jump start.

*Roadside Assistance membership is free. Some services may incur costs. Courtesy Care is available to retail, retail lease and corporate lease customers operating 1994 and newer Chevrolet vehicles for a period of 3 years/36,000 miles. All Courtesy Care services and associated costs must be prearranged by Chevrolet Roadside Assistance or dealer service management and must be driver-initiated. Basic Care and Courtesy Care are not part of or included in the coverage provided by the New Vehicle Limited Warranty. Chevrolet reserves the right to modify or discontinue Basic Care and Courtesy Care at any time. Owners should see their dealer for complete details of the Chevrolet Roadside Assistance Program.

Important — a word about this document: We have tried to make this document as comprehensive and factual as possible. We reserve the right, however, to make changes at any time, without notice, in colors, materials, equipment, specifications, models and availability. Some information may have been updated since the time of posting in June, 1998.

A note about Next Generation air bags: Always use safety belts and proper child restraints, even with Next Generation air bags. See owner's manual for more safety information.



Monte Carlo LS Coupe Z34 Coupe

INTERIOR	Monte Carlo LS Coupe	Z34 Coupe
Air Bag - Driver and Right Front-Passenger ¹	S	S
Air Conditioning - with CFC-Free Refrigerant	S	S
Cargo Net - Luggage-Area	O ²	S
Cup Holders - Instrument Panel (60/40 seats)	S	NA
- Center Console (bucket seats)	O	S
Defogger - Electric Rear-Window	O	O
Door Locks - Power	S	S
Floor Mats - Carpeted, Front and Rear	S	S
Gauges - Tachometer, Engine Temperature and Odometer	S	S
Glass - Tinted, Solar-Ray	S	S
Lights, Interior - Delayed Entry/Exit with Theatre Dimming	S	S
Low Engine Coolant Level Monitor Light	S	S
Low Engine Oil Level and Oil Wear Indicator Monitors	S	S
OnStar System - Dealer Installed	O	O
PASS-Key II Theft-Deterrent System	S	S
Remote Keyless Entry System	O ²	S
Scotchgard™ Protection	S	S
Seats - 6-Way Power Driver	O	O
- Custom Cloth, 60/40 Split-Bench, Front	S	NA
- Custom Cloth Front Buckets with Console	O	S
- Leather Seating Surfaces, Front Buckets with Console	O	O
- Split-Folding, Rear	S	S
Speed Control - Electronic	O	S
Steering Column - Tilt-Wheel™	S	S
Steering Wheel - Leather-Wrapped	O ²	S
Stereo - AM/FM Stereo with Cassette Player	S	S
- AM/FM Stereo with CD Player	O	O
- Steering Wheel Controls	O ²	S
Sunroof - Electric Sliding	O ²	O
Temperature Controls - Driver and Front-Passenger	O ²	S
Trunk - Power Opener	O ²	S
Windows - Power with Driver's Express-Down Feature	S	S
Wipers - Intermittent Variable Windshield	S	S
EXTERIOR		
Daytime Running Lamps with Automatic Exterior Lamp Control	S	S
Exhaust System - Stainless-Steel (dual outlets on Z34)	S	S
Mirrors - Outside Dual Body-Color Remote Electric	S	S
Moldings - Body-Color, Body-Side	S	S
Spoiler - Rear Decklid	O	O
Tires - P205/70R-15 All-Season	S	NA
- P225/60R-16 All-Season	O ³	NA
- P225/60R-16 Goodyear Eagle RS-A Performance	NA	S
Wheel Covers - 15" Bolt-On	S	NA
Wheels - 16" Sporty Aluminum	O ⁴	NA
Wheels - 16" Machined-Face Aluminum	NA	S
FUNCTIONAL		
Brakes - 4-Wheel Antilock (ABS)	S	S
- Power, Front Disc/Rear Drum	S	NA
- Power, Front/Rear Disc	NA	S
Engine - 3100 V6 SFI	S	NA
- 3800 Series II V6 SFI	NA	S
Fuel Tank - 16.6-Gallon Capacity (approx.)	S	S
Suspension - 4-Wheel Independent	S	S
- Ride and Handling	NA	S
Transmission - 4-Speed Electronically Controlled Automatic	S ⁵	S ⁶

S — Standard. O — Optional (some options may be available only as part of a Preferred Equipment Group). NA — Not Available. 1 Always use safety belts and proper child restraints, even with Next Generation air bags. See the owner's manual for more safety information. 2 Requires optional PEG 15B. 3 Requires optional (RPO PY0) 16" sporty aluminum wheels. 4 Requires optional (RPO QNX) P225/60R-16 tires. 5 4T60-E transmission. 6 4T65-E transmission.

1999 MONTE CARLO SPECIFICATIONS

MONTE CARLO®

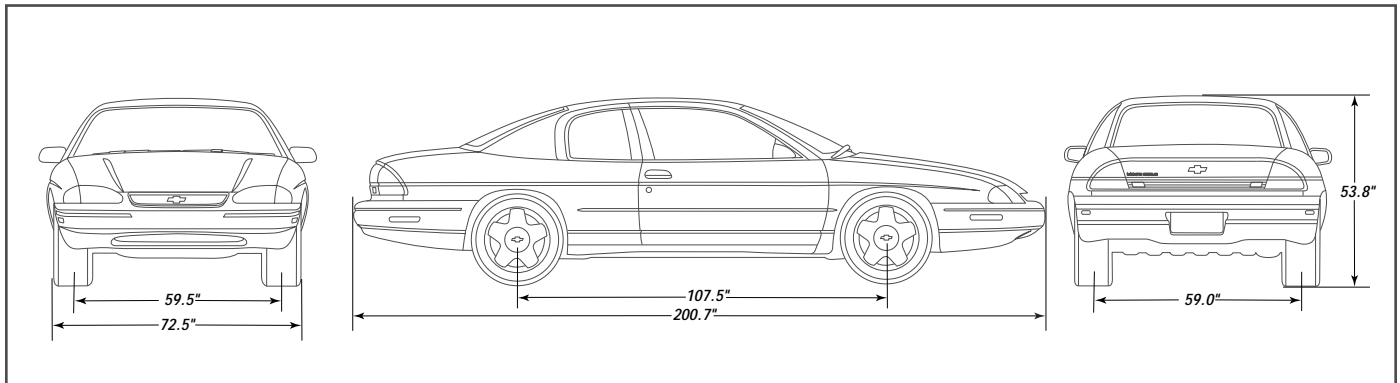

MODEL AVAILABILITY

Monte Carlo LS and Monte Carlo Z34

EPA vehicle class	Midsized
Assembly	Oshawa, Ontario, Canada

DIMENSIONS & CAPACITIES (inches/millimeters, unless otherwise noted)

Exterior Dimensions

Wheelbase	107.5/2730.5
Length (overall)	200.7/5097.8
Width (overall)	72.5/1841.5
Height (overall)	53.8/1366.5
Tread — front	59.5/1511.3
Tread — rear	59.0/1498.6

Interior Front Dimensions

Headroom	37.9/962.7
Legroom	42.4/1077.0
Shoulder room	57.5/1460.5
Hip room	53.4/1356.4

Interior Rear Dimensions

Headroom	36.9/937.3
Legroom	34.9/886.5
Shoulder room	57.6/1463.0
Hip room	51.6/1310.6

Capacities

Passenger capacity	6 (5 with front bucket seats)	
Passenger index (cu. ft./liters)	96.1/2728.5	
Cargo index (cu. ft./liters)	15.5/440.1	
Fuel tank capacity (gal./liters, approx.)	16.6/62.8	
EPA interior index (cu. ft./liters)	111.6/3168.6	
Curb weight (lbs./kg, est.)	3306/1470 (LS)	3436/1559 (Z34)
Engine oil (quarts/liters)	4.0/3.8	
Engine coolant (quarts/liters)	11.3/10.7 (3100 V6)	11.7/11.1 (3800 V6)



STEERING

Type	Power rack-and-pinion	
Ratio (overall)	15.7:1	
Turns stop-to-stop	2.60/2.26 with 16" tires	
Turning diameter curb-to-curb (ft./m)	36.7/11.2 (LS)	39.0/11.9 (Z34)
Turning diameter wall-to-wall (ft./m)	42.4/12.9 (LS)	44.5/13.6 (Z34)

BRAKES

Type	4-wheel ABS, power front disc/rear drum standard on LS (power 4-wheel disc standard on Z34)	
	U. S. STANDARD	METRIC
Gross lining, front/rear	26.0/61.4 (18.4 w/Z34) sq. in.	167.8/396.0 (116.1 w/Z34) sq. cm
Front disc rotor outer diam. x thickness	11.1 x 1.0 in.	281.9 x 25.4mm
Rear drum/rear disc diam. x width	8.86 x 1.8 (LS)/11.0 x .43 (Z34) in.	225.0 x 45.7(LS)/279.4 x 10.9 (Z34) mm
Total swept area, front/rear	180.6/98.6 (160.3 w/ Z34) sq. in.	1165.2/636.2 (1034.3 w/Z34) sq. cm

ENGINES

Model	LS	Z34
Type	3100 V6 SFI	3800 V6 SFI
Block	Cast iron	Cast iron
Cylinder head	Cast aluminum	Cast iron
Hydraulic lifters	Roller	Roller
Bore & stroke (in.)	3.51 x 3.31	3.80 x 3.40
(mm)	89.0 x 84.0	96.5 x 86.4
Cam drive	Chain	Chain
Redline (RPM)	6000	6000
Displacement (liters/CID)	3.1/191	3.8/231
Compression ratio	9.6:1	9.4:1
Fuel induction	SFI	SFI
Horsepower/kW @ engine RPM	160 @ 5200/119 kW @ 5200	200 @ 5200/149 kW @ 5200
Torque/N-m (lb.-ft. @ engine RPM)	185 @ 4000/251N-m @ 4000	225 @ 4000/305 N-m @ 4000
Exhaust system	Stainless steel	Stainless steel
Tailpipe(s)	Single	Dual
Ignition system	Direct ignition system	Direct ignition system
Delcotron alternator rating (amps)	100	105
Battery (SAE capacity rating, cca)	600	690
Recommend fuel (unleaded)	87 octane	87 octane

TRANSMISSIONS

Model	4-speed automatic (4T60-E)	4-speed automatic (4T65-E)
Engine	3100 V6	3800 V6
Type	FWD	FWD
Layout	Transverse	Transverse
Gear ratios:		
1st	2.92	2.92
2nd	1.57	1.57
3rd	1.00	1.00
4th	0.71	0.71
Reverse	2.39	2.39
Final-drive ratios	3.29	3.29

1999 MONTE CARLO SPECIFICATIONS

MONTE CARLO®



CHASSIS

Chassis

Structure/frame	Unitized body frame
Body material	Steel
Suspension — Front	
Type	Independent MacPherson strut with coil springs and stabilizer bar, One-piece "A" arms
Stabilizer bar design/diameter (mm)	Linkless/32 (34 on Z34)
Suspension — Rear	
Type	Independent MacPherson strut with coil spring and stabilizer bar, lateral links attached to body cross member, trailing arms
Stabilizer bar design/diameter (mm)	Link/16 (20 on Z34)

MILEAGE/PERFORMANCE*

Powertrain	3100 V6 SFI		3800 V6 SFI	
	MPG	litres/100kg	MPG	litres/100kg
Mileage:				
City	20	11.8	19	12.4
Highway	29	8.1	30	7.8
Combined	23	10.2	23	10.2
Est. Cruising Range:	mi.	km	mi.	km
City	332	534	315	506
Highway	481	773	498	801
Combined	382	614	382	614

*Based on projected 1999 EPA fuel economy estimates.

TRAILERING INFORMATION

Trailer classification	Light
Gross trailer weight (lbs./kg, up to)	1000/454
Max tongue load (lbs./kg)	100/46

WHEELS & TIRES

Wheel type/size	Steel 15" x 6" (LS)/Aluminum 16" x 6.5" (optional on LS/standard on Z34)
Tire type	All-season steel-belted radial-ply
Tire size (standard)	P205/70R-15 (LS)/P225/60R-16 (optional on LS/standard on Z34)
Spare size	T125/70D-15

All specifications are preliminary and subject to change.